

Hammers

Skid Steer Loader



Hammer Model

Certified Impact Energy

H50/H50s

198 J

H63/H63s

372 J

Caterpillar® Skid Steer Loader Hydraulic Hammers

Constant blow energy with a high impact frequency resulting in an excellent output power in a compact size.

Performance and Versatility

Cat® H50/H50s and H63/H63s Hammers are designed to deliver maximum performance and provide smooth, efficient operation when matched to the Cat Skid Steer Loader's responsive hydraulics. High frequency allows the hammer to penetrate concrete and asphalt quickly and effectively. A variety of hammer tools are available to meet a wide array of breaking requirements.

Ease of Operation

Cat Hammers were designed with the operator in mind and provide easy operation when coupled to Cat Skid Steer Loaders. A step is conveniently located on the mounting bracket to facilitate safe and easy operator entry and exit when the loader arms are fully lowered and the hammer is positioned flat on the ground. The coupler interface is matched to the machine's universal mechanical quick coupler for fast, secure work tool changes.

Application

Caterpillar Hydraulic Hammers are designed for various breaking applications including the following:
Road Construction- An essential tool during improvements and upgrading. The hammer works well on removing existing curbs, traffic islands, ramps, driveways, or sections of concrete.
Demolition- The hammer-equipped Skid Steer can be used to break up fallen wall sections and floor sections as well as handling foundations, and other brick and concrete structures at ground level.



Features:

There are two sizes of hammers to match the range of Skid Steers- H50 and H63. These are also available as sound suppressed (H50s, H63s). All models include the following features:
Low Pressure Accumulator- Assists in the power stroke of the piston.
High Pressure Accumulator- Dampens pressure peaks thus protecting the carrier hydraulic system and hydraulic quickdisconnects for longer life.
Distributor- High oil volume for greater blow frequency thus greater productivity.
Pressure Adjusting Valve- Assures that all blows are delivered at a constant blow energy.
Piston- Long heavy piston delivers maximum impact energy and minimizes recoil forces to carrier.

Slip Fit Thrust Ring- Dissipates harmful shock loads in abusive applications for longer life.

Tool Retention Pin System- Allows quick and easy removal of the tool.
Slip Fit Lower Tool Bushing (Field Replaceable)- Grease retention grooves for better lubrication, and visual checks of wear limit.

Cat Hammers utilize proven components such as Cat hydraulic hose, couplings, o-ring face seals, and rotating lower tool bushing with visual wear indicators (also field replaceable). Each of these components are readily available and easily replaceable to help extend hammer life, simplify servicing and reduce downtime.

Specifications/Dimensions

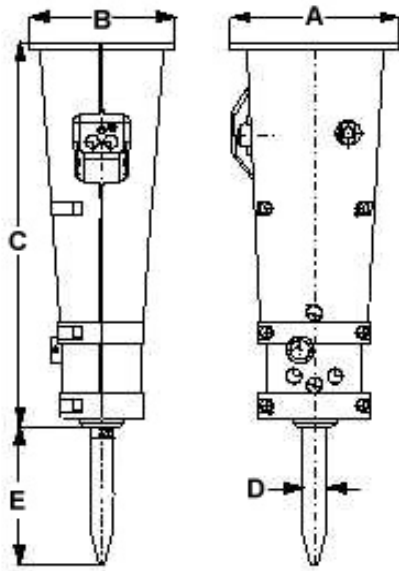

		H50/H50s	H63/H63s
A Overall width with bracket	mm	340	470
	mm	440	440
B Housing width	mm	280	380
	mm	316	380
C Hammer length	mm	925	1025
	mm	918	1025
D Tool width	mm	50	63
E Tool length	mm	261	364
Recommended carrier weight	kg	2500-4500	3000-6500
Operating weight*	kg	200	300
	kg	220	315
Impact Frequency	blows per minute	450-1800	400-2000
Impact Energy (certified)**	J	198	372
Acceptable Oil Flow	l/min	20-70	20-100
Operating Pressure	kPa	10 500	13 000

* Operating Weight includes hammer, standard tool and average mounting bracket.

** Certified by CIMA- MBMB (Construction Industry Manufacturers Association Mounted Breaker Manufacturers Bureau).

Compatibility

Following are the recommended and approved Caterpillar Mini Hydraulic Excavator/Hydraulic Hammer combinations for maximum system performance.

	H50/H50s	H63/H63s
216	●	■
226	●	■
236	!	●
246	!	●

● Provides optimum system performance.

■ Provides acceptable system performance.

! Not approved. Do not use.

Skid Steer Loader Hydraulic Hammers

HEHX2662 (10/2000)

Materials and specifications are subject to change without notice.
Featured machines in photos may include additional equipment.
See your Caterpillar dealer for available options.

© 2000 Caterpillar

